

To replace :
Serrures pour portes coulissantes

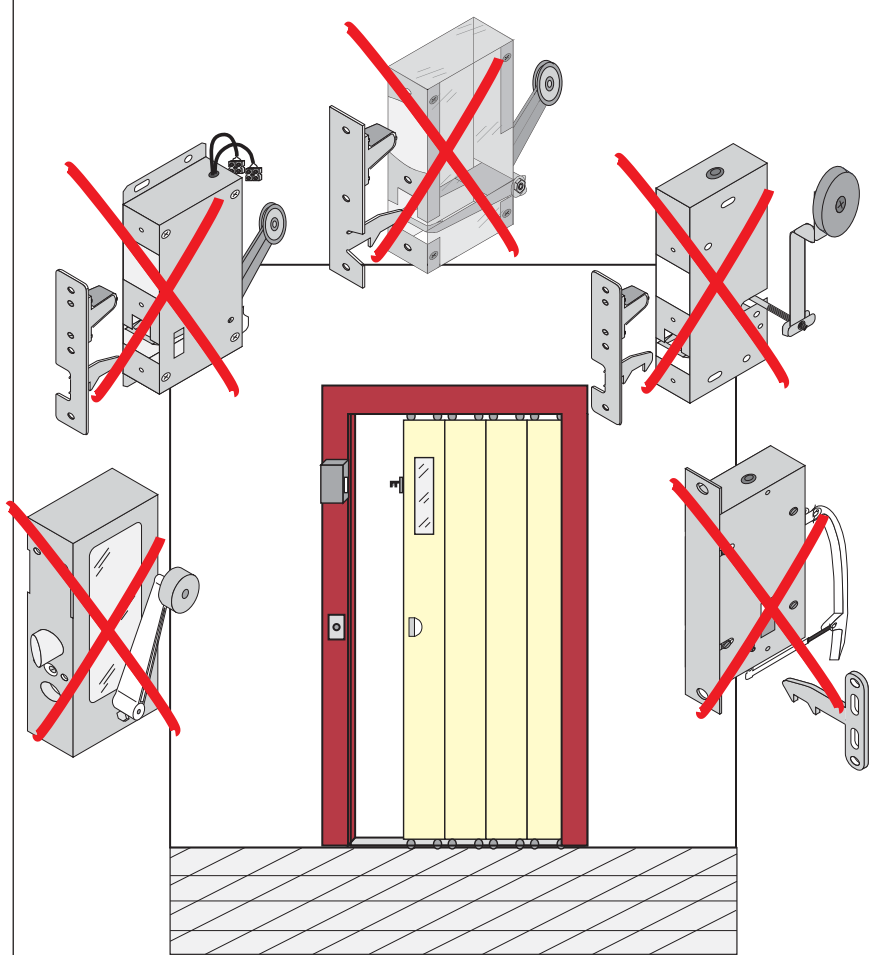

Substitution :
LR 180 ** GC-N (prudhomme S.a.)
(sliding door with manual opening)
LR 180 ** GC-N/PM (prudhomme S.a.)
(sliding door with pneumatic opening)*

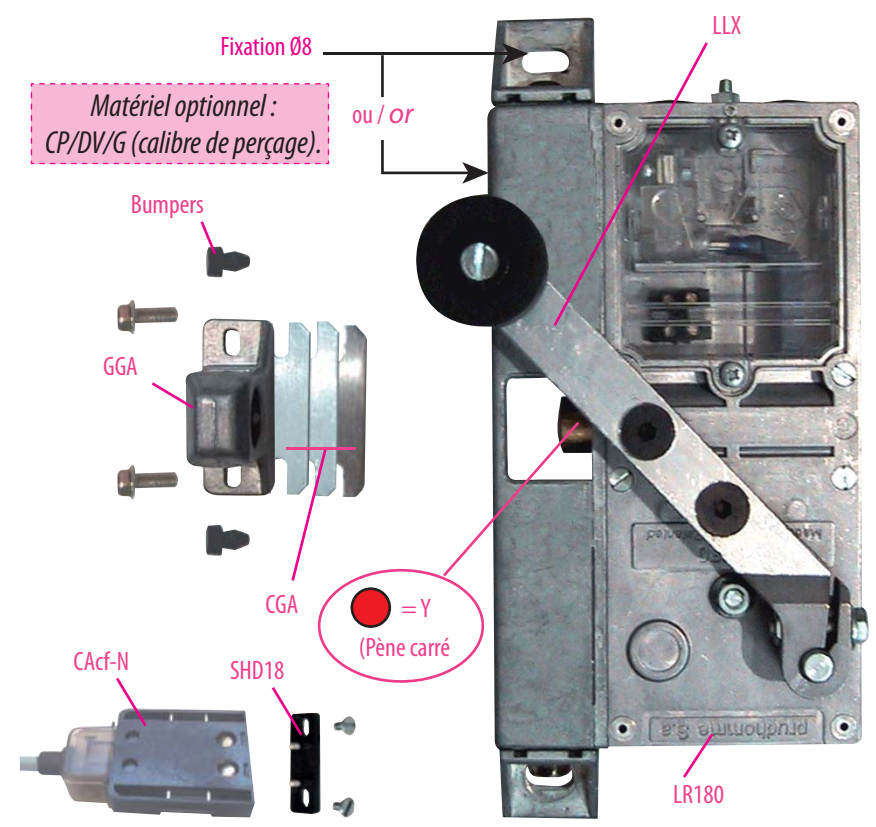

* (in pneumatic door : lock not release)

réf.:LR180 * **G** GC-N

réf.:LR180 * **D** GC-N

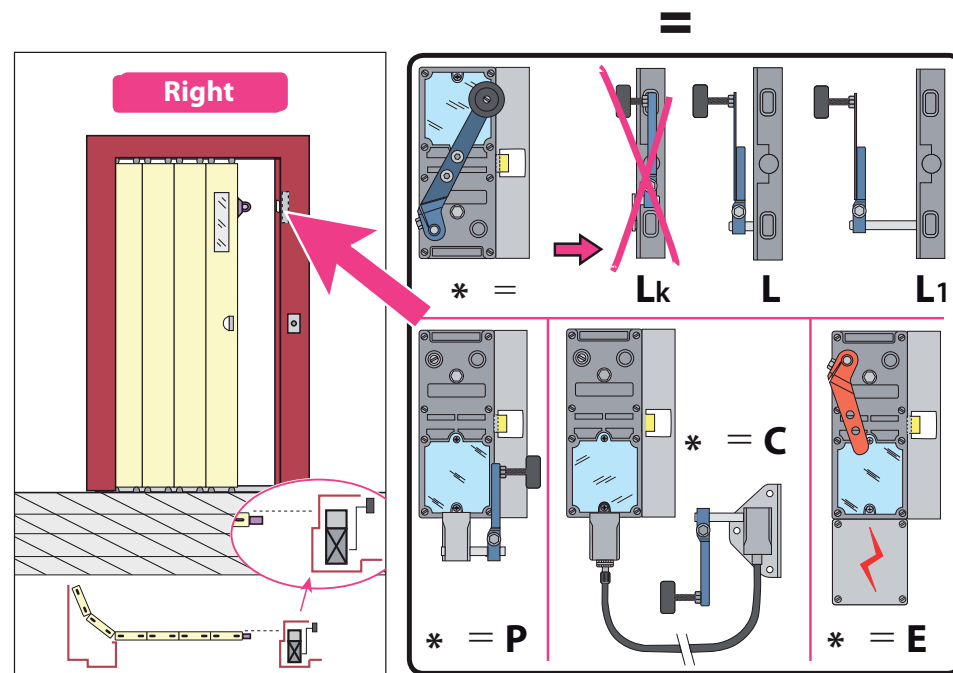
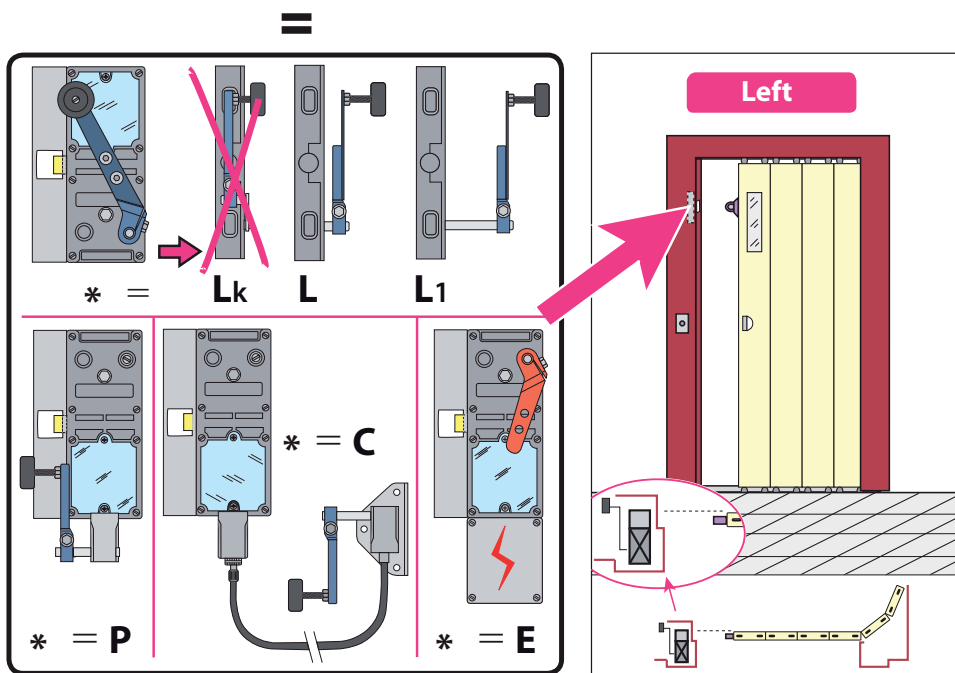

Mounting stages

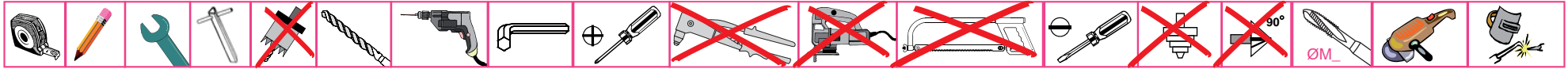

1 Marking the door with a pencil and a $\varnothing 6,5$ drill bit.

2 Preparing the door profile.

3 **Fixation A**: Mounting the LR180 bracket. **Fixation B**: Marking the second bracket position.

4 **Fixation A**: Mounting the second LR180 bracket. **Fixation B**: Drilling a $\varnothing 9$ hole.

5 **Fixation A**: Mounting the LR180 bracket. **Fixation B**: Drilling a hole.

6 Mounting the LR180 bracket. **GGA**: Mounting the GGA component.

7 Mounting the CP/DV/G plate. Drilling holes with $\varnothing 3,2$ and $\varnothing 14$ bits.

8 Mounting the M6 screw.

9 Mounting the CGA and GGA components.

10 Mounting the SHD18 handle. Drilling holes with $\varnothing 4$ and M4 screws.

11 Mounting the GGA component. Drilling a $\varnothing 10$ hole.

12 Mounting the GGA component. Drilling a $\varnothing 6$ hole. Mounting the CT80 and CacF-N components.

13 Final assembly of the lock mechanism.